

LattePremio

Perfect frothed milk within seconds

GB	Operating Instructions	NO	Instruksjoner
NL	Gebruiksaanwijzing	SE	Bruksanvisning
DE	Bedienungsanleitung	FI	Käyttöohjeet
FR	Notice d'utilisation	DK	Betjeningsvejledning
IT	Istruzioni per l'uso	RU	Инструкция по эксплуатации
ES	Instrucciones de Operación	AE	تعليمات التشغيل
GR	Οδηγίες λειτουργίας		



Table of Contents

Appliance description	7
1. Before the first use	8
2. Daily, before use	8
3. Preparation	9
Cappuccino	9
Caffè Latte / Hot milk	9
Latte macchiato	9
Increasing capacity	9
4. Programming the fill up level / default time	10
Heating	10
Frothing	10
Reset to factory settings	10
5. Energy saving mode	10
6. Protection function	11
7. Cleaning the Appliance	11
Before the cleaning process	11
Cleaning programs	11
8. Descaling	12
Decalcification	12
9. Troubleshooting	13
10. Storage / Disposal	13
11. Technical data	13

Before the first use or after a longer period of non-use

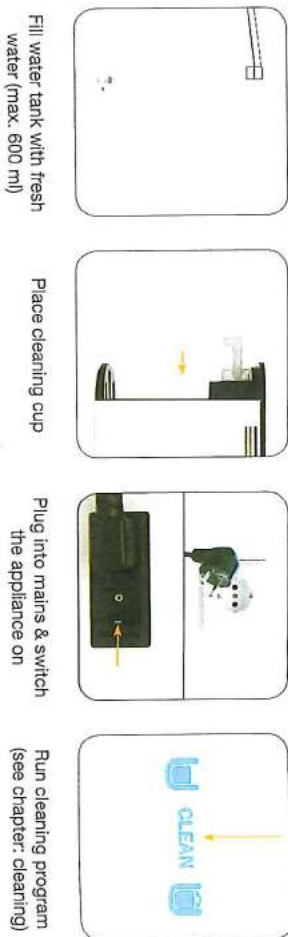

NOTE

- Do not use sparkling water or distilled water in watertank. Use ordinary tapwater, or still bottled water when living in a hard water area.
- Do not place the appliance in direct sunlight, near oven or other hot surfaces to prevent the milktemperature in the milktank to increase.

Daily, before use



NOTE

- Milk must be stored in the refrigerator at 4°C before use.
- In order to keep the milk fresh we recommend to refresh the milk in the milktank every hour.
- For best frothed milk performance we recommend to run the appliance once in frothing function with milk in order to remove any air and water out of the frothead

Preparation

Cappuccino

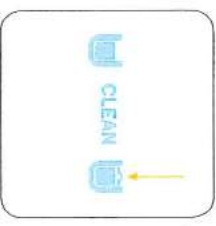

Place cup on drip tray

Press button B

Caffe Latte / Hot milk

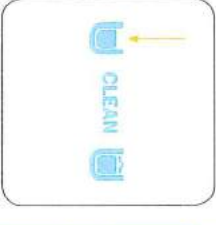

Place cup on drip tray

Press button A

Latte Macchiato

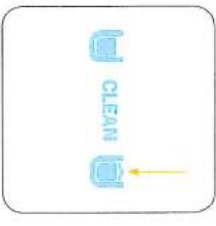

Replace high driptray for low drip tray

Place a Macchiato glass underneath the milk outlet

Press button B

NOTE

- If not in use: store milktank into refrigerator
- Temperature: Hot milk: approx. 50 °C, Milkfoam: approx. 60 °C

Increasing capacity



Remove front cover

Attach extension hose

Place extension hose in external container / milkcarton

Programming the fill up level / default time

Heating (default time 30 sec. / approx. 120 ml hot milk)



Press A for approx. 3 seconds until it flashes

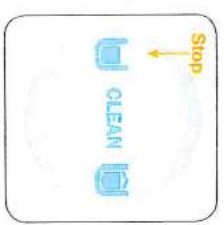

Press A again to set the cup volume



Setting range cup volume 5 - 60 seconds

Frothing (default time 20 sec. / approx. 100 ml foam & milk)



Press B for approx. 3 seconds until it flashes



Press B again to set the cup volume

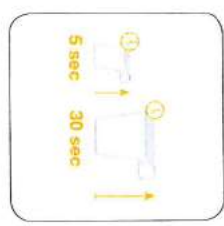

Setting range cup volume 5 - 30 seconds

4.3 Reset to factory settings



Press both buttons simultaneously for 3 seconds

Energy saving mode

- After 5 minutes of NON using the appliance, the appliance will automatically switch into energy-saving mode. The buttons will light up alternately.
- By pressing either one of the buttons, the appliance will resume in normal function mode.
- The energy-saving mode time can be changed from 5 minutes (factory default time) to 30 minutes.
 - For 5 minutes setting: press and hold button A and switch on power until all buttons light up.
 - For 30 minutes setting: press and hold button B and switch on power until all buttons light up.

Protection function

- The CLEAN button will flash fast when the front cover or the milktank will be removed from the appliance.

Cleaning the appliance

Before starting the cleaning process

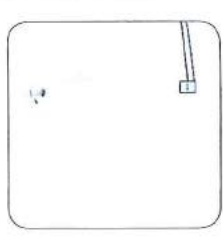

Fill water tank with fresh water (max. 600 ml)



Take out the milk tank and place cleaning cup



Fill the milk tank with water for thorough cleaning (min. 200 ml / max. 600 ml)

This appliance has two cleaning programs: short clean & long clean

The application is as follows:

Long clean x2

- Before the first use
- After long periode of non-use
- When appliance not in use
- At the end of the day after use

Short clean

- Before the first use every day
- Between each cups if there is an interval time of more than 30 minutes.

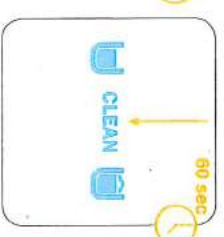
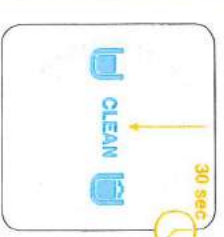

NOTE
 • It is compulsory to clean the front cover and the froth head in water after the LONG CLEAN program, for hygienic purposes. The milk tank and suction pipe must be cleaned after use. It is recommended to immerse them in warm water overnight.

Press the button once for a short program (30 seconds) Hold the button for > 2 sec. to start a long program (60 seconds)

Cleaning the outside of the appliance

- Remove the plug from the outlet before cleaning the appliance.
- Wipe outside with a soft, dry cloth, after the appliance is cooled down. Never use metal polish!
- The removable items are NOT dishwasher safe

Descaling

NOTE

- Run decalcification every 3 months or after 300 cycles.
- Total run time is 5 mins at a watertemperature of 65 °C
- Start the decalcification program only when the appliance is COLD (CLEAN button lights up). Decalcification program will not start if appliance is HOT (All buttons light up)

Preparation

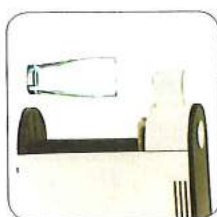
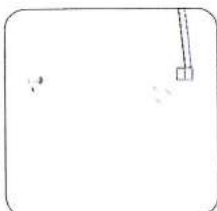

Switch off the appliance and remove all accessories

Fill water tank and add descaler to recommended ratio on box

Place large glass or container underneath the milkoutlet

Decalcification

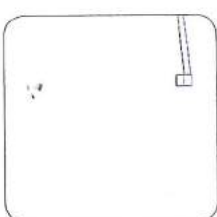

Hold down the clean button and switch on power until all buttons light up

When CLEAN button lights up the appliance is ready for decal cycle. Press CLEAN button

After decalcycle clean and refill water tank* (keep appliance switched on)

Press CLEAN button once for 5 min, run with tap water. Run 2 times

NOTE

- * Make sure there is no descaler left in water tank.
- After decalcification & rinse process, switch off the appliance to exit the decalcification mode.

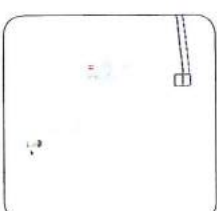
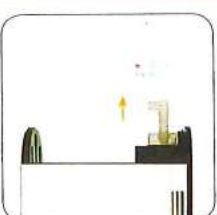

Switch appliance off, remove water tank and froth head

Clean the water tank and froth head under tap water

Attach froth head and cleaning cup and switch appliance on

Run the 'Long clean' program at least 2 times. After this the appliance is ready for use

Troubleshooting

Faults	Possible cause	Repairs
Indicator lights do not flash after switching on the appliance	Plug not in socket or power cord connector	Connect plug
No milk flow	• Water tank empty • Front cover not attached properly	• Fill water tank • Attach front cover
Button B flash fast	• Suction pipe from milk tank lid not assembled • The appliance is overheated	• Connect suction pipe to lid from milk tank • Switch appliance off until it is cooled down. Then switch on again. If button B still flashes fast contact service center.
Button A flash fast	• Environment is too cold. Less than 5 degree °C	• Place the appliance to room temp environment. If button A still flashes fast contact service center.

NOTE

- If you cannot solve the problem following the steps outlined above, please contact the customer service.

Storage / Disposal

If you do not need the appliance for an extended period of time, allow it to cool down and clean the appliance as described in the chapter Cleaning and Care to prevent mould formation. Mould fungus represents a health risk and stains may develop on the unit which can no longer be removed. Electric and electronic end-of-life appliances often still contain valuable materials. However, they also contain hazardous substances which were required for their proper function and safety. If disposed of with regular household waste or treated incorrectly they can pose a risk to human health and the environment.

NOTE

- Use the collecting station in your municipality to return electrical and electronic end-of-life appliance for recycling. Obtain the information required, if necessary, from your city hall, your waste disposal company or your dealer.
- Render the appliance unusable before disposal. Make sure your end of life appliance is stored safely away from children until hauled away.

Technical data

Dimensions (W x H)	254 x 360	mm
Approx. weight	3,34	kg
Operating voltage	220-240	V
Frequency	50 - 60	Hz
Power consumption	1000	W
Length of cable	1,5	m
Water tank	600	ml
Milk tank	600	ml