

Model S12 / Velocissimo

English Instruction book

Australia

Ph: 1800 239 438

www.mapcoffee.com.au

New Zealand

Ph: 0800 726 713

www.mapcoffee.com



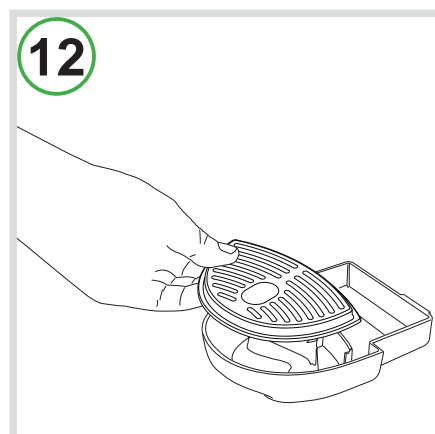
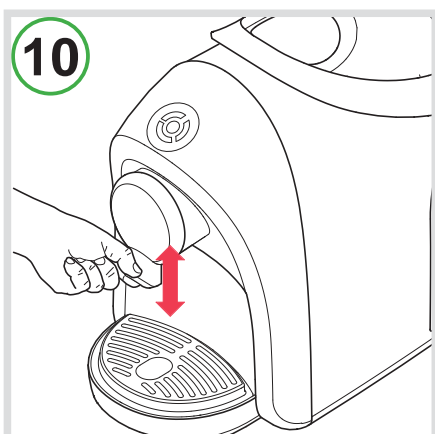
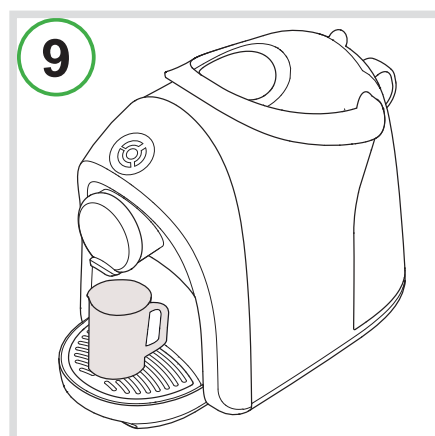
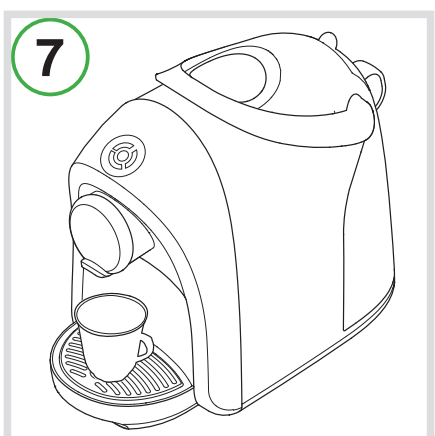
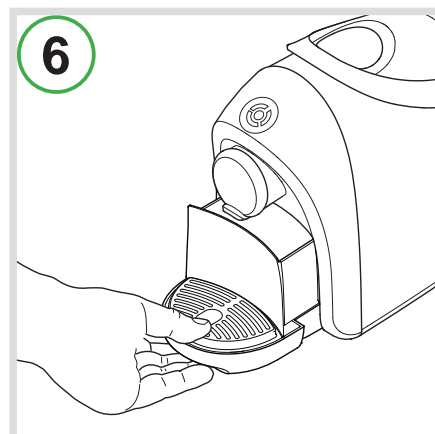
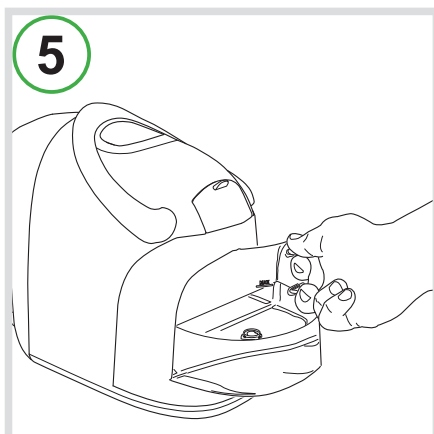
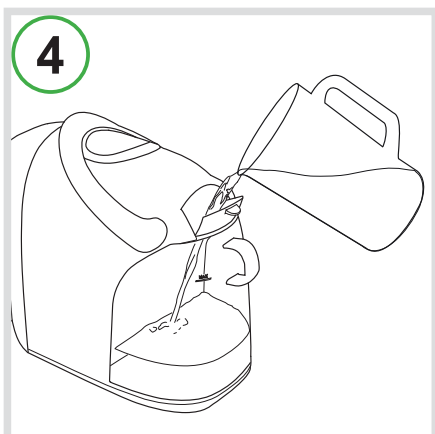
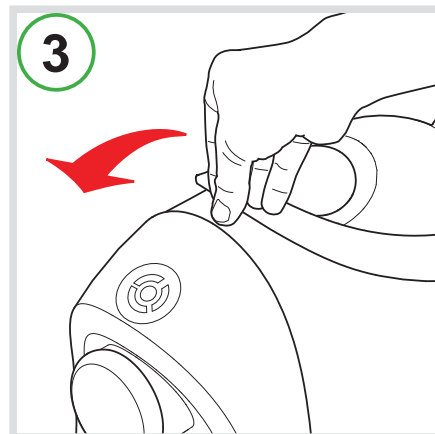
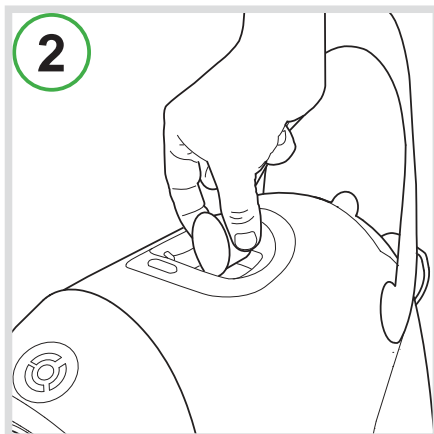
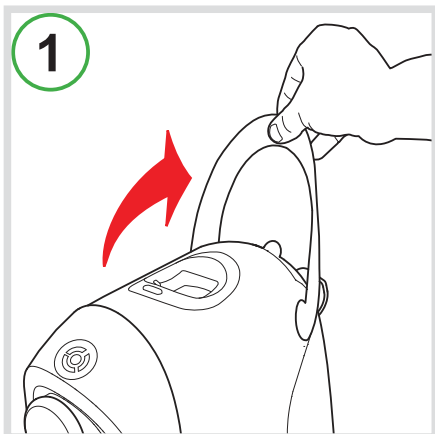

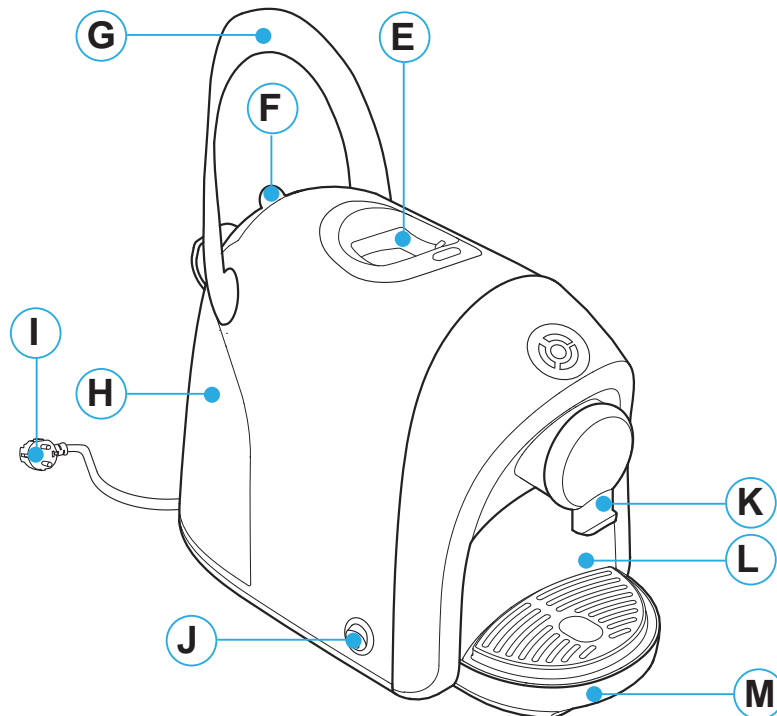
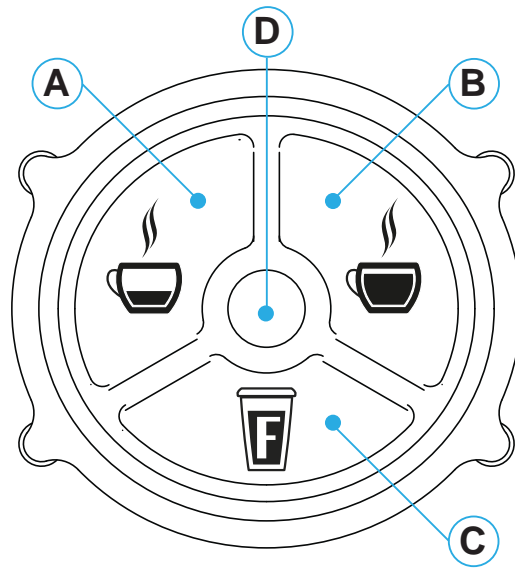
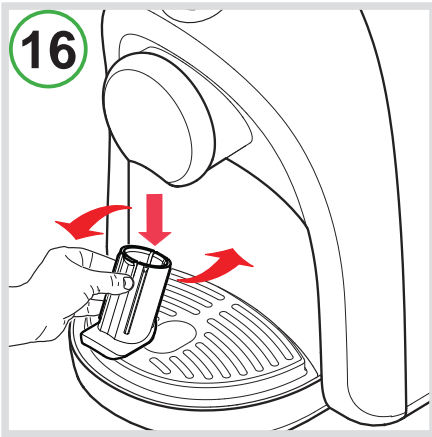
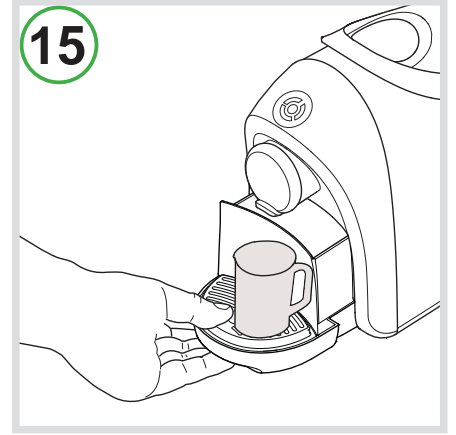
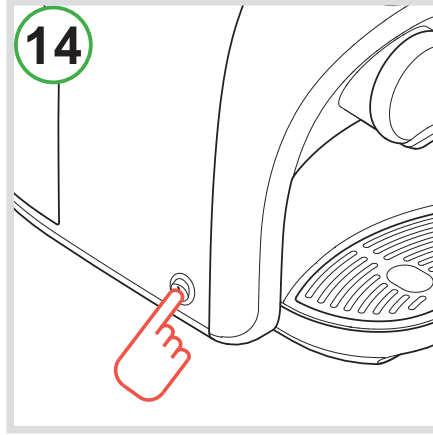
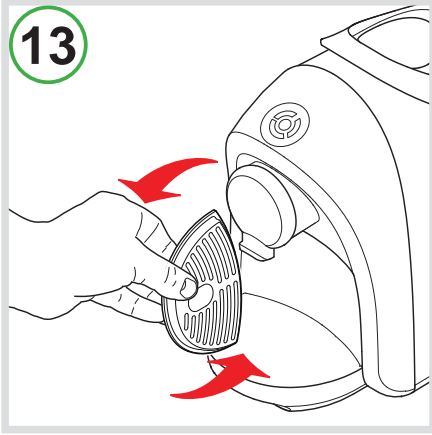

English

- A: “Espresso” button;
- B: “Coffee” button;
- C: “Long coffee (F)” button;
- D: “Multifunction” indicator light;
- E: Capsule compartment;
- F: Water tank cover;
- G: Lever for opening / closing capsule compartment;
- H: Water tank;
- I: Power cord;
- J: Power on/off switch;
- K: Dispensing spout (adjustable);
- L: Used capsule drawer;
- M: Drip tray;

CONTENTS

Introduction:

- Follow the instructions (Symbols).....6
- Your Caffitaly System contact6
- Safety warnings.....7
- Instructions for use and disposal.....8

Installation:

- **First use or after a long period of disuse**.....8
- Turning on the appliance.....8
- General operating indications.....9
- Adjusting the cup/espresso cup height.....9

Dispensing the product:

- **Correct use of the buttons**9
- Dispensing coffee.....10
- Programming the quantity of coffee in a cup.....10

Cleaning and Maintenance:

- Saving energy10
- Daily maintenance.....10
- Descaling.....11

Miscellaneous:

- Troubleshooting.....12
- Technical data12

Thank you for having chosen our product and for your confidence in our company. You can savour your favourite hot beverages at any time of the day with our appliance by choosing one of the capsules that Caffitaly System offers. For example: an espresso, a cocoa-flavoured beverage or a tea will be ready in just a few seconds.

Follow the instructions (Symbols)



Warning.

This is the safety warning symbol.

It is used to call your attention to potential personal injury hazards.

Abide by the safety messages provided in order to avoid possible injury or death.



Note.

This symbol is used to highlight some actions that will optimise machine use.



Not dishwasher safe



Cleaning advice

Your Map Coffee Contact

Australia

Ph: 1800 239 438

www.mapcoffee.com.au

New Zealand

Ph: 0800 726 713

www.mapcoffee.com

Safety warnings

CAREFULLY read the following instructions!

In this way you will avoid the risk of personal injury and damage to the appliance.

- This appliance is designed for domestic use and similar purposes, for example: staff kitchen areas in shops, offices and other workplaces; in hotels, farm lodges, motels, Bed & Breakfasts and other residential environments.
- Use only Caffita System capsules.
- Use of the appliance in any manner other than as directed herein could cause harm to persons and void the guarantee. The manufacturer will not be responsible for injury or damage resulting from improper use of the appliance.
- After removing the packaging, check that the appliance is not damaged. If damage is found, or upon the first sign of a defect (unusual noise or odours), or if any problem occurs inside the appliance, do not use it and contact an Authorised Service Centre.
- The packaging elements (plastic bags, etc.) must not be left within reach of children as they are potential sources of danger.
- Only use the appliance if the power cord is intact. If the cord is damaged, it should be replaced: contact an Authorised Service Centre. Lethal danger of electric shocks.
- Only use and store the appliance indoors. Make sure the electrical elements, plug and cord are dry. Never submerge the appliance in water. Protect the appliance from sprays and drips. Water and electricity together constitute a risk of electrocution.
- Only connect the appliance to power outlets complying with the requirements of the law. Make sure that the power supply voltage matches the rating shown on the data plate, located on the bottom of the appliance.
- The surface on which the machine is installed must be level, solid, stationary and heat resistant; the bearing surface must not exceed an angle of 2°.
- Do not allow the appliance to be used by children or persons with impaired mental, physical or sensory faculties or insufficient experience and/or skills, unless they are under the careful supervision and guidance of a person responsible for their safety. Children must be kept under supervision to prevent them from playing with the appliance.
- Do not leave the power cord near hot surfaces, sharp edges or other sharp objects.
- Never place your hands inside the capsule compartment. Danger of injury.
- Always close the lever. Never open the lever while a beverage is being dispensed.
- Never remove machine parts, except those indicated in the instructions for daily maintenance.
- Do not insert objects into the openings. This could cause electric shocks! Any operation that is not described in this instruction manual should only be performed by an Authorised Service Centre!
- Do not pull on the power cord to disconnect it. Remove the plug to avoid damaging it.
- Descale the appliance regularly, following the instructions provided. If you do not, the appliance may be damaged.
- Clean the appliance carefully and regularly. If it is not cleaned, the build-up that forms may be hazardous to your health. Unplug the appliance and allow it to cool before cleaning.
- If you do not expect to use the appliance for a long period of time (leaving on vacation, etc.), unplug it.

Instructions for use and disposal



The appliance has been manufactured using high quality materials that can be reused or recycled. Dispose of the appliance in a suitable waste collection centre.

At the end of its useful life, the product should not be disposed of with unsorted household waste. It should be taken to a suitable selective waste collection centre set up by the local authorities or returned to a retailer who provides this service.



Separate collection of an electrical household appliance avoids a possible negative impact on the environment and health arising from improper disposal and enables the materials it is made of to be recovered so as to achieve significant savings of energy and resources. The crossed-out wheeled bin symbol applied on the product highlights the need to dispose of electric appliances separately. Improper disposal of the product by the user shall be subject to specific administrative sanctions as provided for under current regulations.

The packaging is made from recyclable materials. Contact the relevant authorities for information regarding local legislation.

First use or after a long period of disuse

- Fill the tank with fresh, still water (Fig. 4).
- Plug in the appliance and turn it on (Fig. 14).
- Make sure the lever is closed (Fig. 3).
- As well as buttons **A-B-C**, warning light **D** also blinks in **RED**.
- Place a large container (at least 250 ml) under the dispensing spout (Fig. 9).
- Press one of the buttons **A-B-C**. Wait for the machine to complete the priming cycle and fill with water. Warning light **D** will switch off.



NOTE: if, at the end of the priming cycle, buttons **A-B-C** and warning light **D** continue to blink, repeat the procedures as listed in the previous step.

- Buttons **A-B-C** will blink simultaneously to indicate that the machine is warming up.
- When buttons **A-B-C** turn on and remain steadily lit, and the appliance emits 2 beeps, perform a rinse by pressing button **C**. Press the button again to perform a second rinse. Wait for the machine to complete the rinse cycle.
- At the end of this operation, empty out the water from the used capsule drawer (Fig. 6).

Turning on the appliance

- Fill the tank with fresh, still water (Fig. 4).
- Switch on the appliance by pressing the power on/off switch (Fig. 14).
- Buttons **A-B-C** will blink simultaneously to indicate that the machine is warming up. When the buttons turn on and remain steadily lit, the appliance is ready for use.

General operating indications

DESCALING SIGNAL:

- When warning light **D** blinks **YELLOW** and the machine beeps 3 times, a descaling cycle should be carried out (see ch. Descaling).

HEATING:

- Buttons **A-B-C** blink simultaneously.

WHEN THE WATER RUNS OUT DURING OPERATION:

- The water tank is empty when warning light **D** blinks **RED** and the appliance emits 3 beeps followed by a single intermittent beep.
- Fill the water tank with fresh, still water (Fig. 4).
- Press one of the buttons **A-B-C**. Wait for the machine to complete the priming cycle and fill with water.
- When buttons **A-B-C** turn on and remain steadily lit, the appliance is ready for use.

IF THE LEVER IS RAISED WHILE DISPENSING:

- Raising the lever while dispensing a product (Fig. 1) may cause splashes of hot water.
Danger of scalding!
- Warning light **D** blinks **RED** and the intermittent machine beeps. The appliance will immediately stop dispensing.
- Close the lever (Fig. 3).
- Press one of the buttons **A-B-C** to reset the alarm.
- The appliance is ready for use again.

Adjusting the cup/espresso cup height

- The machine can be adjusted for the use of large cups or espresso cups.
- The machine is initially set for the use of large cups (Fig. 7).
- For optimum results when using espresso cups, lower the end of the dispensing spout (Fig. 10), or lift and twist the rack above the drip tray (Fig. 13).

Correct use of the buttons

To dispense “Espresso” or “Caffè crema”, only use button **A** or **B** (lit in **WHITE**). The same buttons, depending on the quantity, are to be used for dispensing capsules of orzo, ginseng, cocoa or milk.



NOTE: traces of the product just dispensed may remain inside the machine. When dispensing milk, hot chocolate or instant beverages, for full flavour we suggest rinsing the machine by pressing any button (**A**, **B** or **C**) without inserting a capsule. **In any case, we recommend carrying out this procedure at least once a week.**

Dispensing coffee

- Raise the lever to open the capsule compartment (Fig. 1).
- Insert the capsule, pressing it gently into place (Fig. 2).
- Close the lever fully (Fig. 3).
- Place a cup or espresso cup under the coffee dispensing spout (Fig. 7 or 8).
- **Press and release** button **A**, **B** or **C**, depending on the desired coffee.
- The pressed button will flash. The machine will stop dispensing on reaching the programmed quantity and emit a beep. We recommend a maximum of 60mls for coffee capsules for optimal extraction and flavour.
- Raise the lever to eject the used capsule into the drawer (Fig. 1).
- Close the lever (Fig. 3).



NOTE: the quantities of coffee dispensed can be programmed according to personal taste and the size of the cups or espresso cups used.

To program the quantities, please refer to ch. "Programming the quantity of coffee in a cup".

Programming the quantity of coffee in a cup

- Raise the lever to open the capsule compartment (Fig. 1).
- Insert the capsule, pressing it gently into place (Fig. 2).
- Close the lever fully (Fig. 3).
- Place a cup or espresso cup under the dispensing spout (Fig. 7 or 8).
- Press **and hold** the desired coffee button.
- On reaching the desired amount of coffee, release the button. Now the button is programmed. **The quantity of coffee dispensed can be programmed from a minimum of 20 up to a maximum of 250 ml.**
- Raise the lever to eject the used capsule into the drawer (Fig. 1).
- Close the lever (Fig. 3).

Saving energy



The machine will automatically reduce consumption after 1 hour of inactivity. Buttons **A-B-C** blink slowly and sequentially. To restore normal operating conditions, press any button or raise the lever. The appliance will start warming up.

When buttons **A-B-C** turn on and remain steadily lit, the appliance is ready for use.

Daily maintenance

- Remove the drip tray and used capsule drawer (Fig. 6).
- Lift the used capsule drawer (Fig. 11); empty and rinse it.
- Remove the grid (Fig. 12). Empty the drip tray and rinse it out with water.
- Remove the water tank (Fig. 5); empty and rinse it.
- Remove the dispensing spout by twisting it slightly and pulling firmly downwards (Fig. 16). Wash it in hot water.



NOTE: traces of the product just dispensed may remain inside the machine. When dispensing milk, hot chocolate or instant beverages, for full flavour we suggest rinsing the machine by pressing any button (**A**, **B** or **C**) without inserting a capsule. **In any case, we recommend carrying out this procedure at least once a week.**



Use a soft cloth and a neutral detergent to clean the surfaces of the appliance. Do not use jets of water to clean the appliance.



The plastic parts of the machine, including the water tank, are **NOT** dishwasher safe.

Descaling

Descaling signal: when warning light **D** blinks **YELLOW** and the machine beeps 3 times, a descaling cycle should be carried out, as illustrated below.



The machine features an advanced program that monitors how much water is used to dispense beverages. This measurement provides the user with indications as to when the machine needs to be descaled.

It is advisable to use the Caffitaly System descaling agent. It is designed to comply with the technical characteristics of the machine, in full observance of consumer safety. The descaling agent must be disposed of in compliance with manufacturer instructions and/or with current regulations in force in the country where the appliance is used.



CAREFULLY read the directions for use on the packaging of the descaling agent. Avoid contact with eyes, skin and machine surfaces.

Switch the machine off during descaling, and do not lift the lever. A person must be present during the operation.







Do not use vinegar: it could damage your machine!

- Switch the machine off by pressing the power on/off switch (Fig. 14).
- Empty and rinse out the used capsule drawer and drip tray (Fig. 6).
- Remove and empty the water tank (Fig. 5).
- Mix the contents of a bottle of Caffitaly System descaling agent with approximately 1 litre of water and pour into the tank.
- Place a container (at least 250 ml) under the dispensing spout (Fig. 9).
- Make sure that the lever is lowered (Fig. 3) and there is not a capsule inside the capsule compartment.
- Press and hold buttons **A** and **B** while switching the machine on by pressing the power on/off switch.
- Button **B** will light up, while warning light **D** blinks **YELLOW** and **RED** alternately.
- Press button **B** to start the descaling cycle.
- The machine dispenses the descaling solution at intervals (**5 doses with a 10-minute pause between each one, for a total duration of about 45 minutes**). During this step, **when the buttons must not be pressed**, warning light **D** blinks **YELLOW** and **RED** alternately.
- If the container fills up, empty it.
- When the cycle is complete, as well as the button **B**, the warning light **D** blinks **YELLOW** and **RED** alternately.
- Carefully rinse out the water tank and refill it with fresh water (Fig. 4).
- Empty and rinse the used capsule drawer, the drip tray and the container used and put them back in place (Fig. 15).
- Press button **B** to start the rinse cycle.
- Rinse water will be run through the machine. During this step, warning light **D** blinks alternately (twice **YELLOW** and twice **RED**).
- When the rinse cycle is complete, in addition to the button **B**, the warning light **D** blinks **YELLOW** and **RED** alternately.
- Carefully empty and rinse out the water tank and fill it with fresh, still water (Fig.4) .
- Empty and rinse out the used capsule drawer and drip tray (Fig.6).
- Press the button **B** to quit the cycle.

Troubleshooting

| PROBLEM | POSSIBLE CAUSE | SOLUTION |
|---|---|---|
| No coffee comes out. Warning light D blinks RED . | <ul style="list-style-type: none"> - The water tank is empty - Interruption in the water flow | <ul style="list-style-type: none"> - Fill the tank with fresh water. Press a button to refill the circuit. When the buttons remain steadily lit, the appliance is ready for use. - Remove capsule from chamber. |
| The coffee is not hot enough. | <ul style="list-style-type: none"> - Cold cups / espresso cups. - Scale build-up in machine. | <ul style="list-style-type: none"> - Preheat the cup. - Descale the machine. |
| The lever cannot be lowered. | <ul style="list-style-type: none"> - The used capsule drawer is full. - Capsule stuck inside the machine. | <ul style="list-style-type: none"> - Empty out the used capsule drawer. - Remove the used capsule. |
| Warning light D is lit steadily in RED . | Heating problems. | Turn off the machine, then turn it back on. If the problem persists, take the machine to an Authorised Service Centre. |
| When a button is pressed to dispense coffee, the machine seems to work but then stops without dispensing any coffee, or only dispenses a tiny amount. | <ul style="list-style-type: none"> - Incorrect quantity programming. - Non compatible capsules are used | <ul style="list-style-type: none"> - Reprogram the quantity associated with that button. See ch. "Programming the quantity of coffee in a cup". - Use only Caffitaly capsules |

Technical data

| | |
|---|--|
|  | See the data plate on the base of the machine. |
|  | Max. 15 bar |
|  | < 70dB A |
|  | About 4 kg |
|  | 1.2 litres |
|  | ambient temperature: 10°C - 40°C |
|  | 170 mm 260 mm 320 mm |

The materials and objects in contact with food products comply with the requirements of European Regulation 1935/2004.



Australia

Ph: 1800 239 438
info@mapcoffee.com.au
www.mapcoffee.com.au

New Zealand

Ph: 0800 726 713
info@jalmasales.com
www.mapcoffee.com